

# PRIME RETAIL PAD

-1.3 AC | **WINTER HAVEN, FL**

Across from New Publix | Signalized Corner | Pad Ready



**SWC Dundee Road and Overlook Drive • Winter Haven, FL**

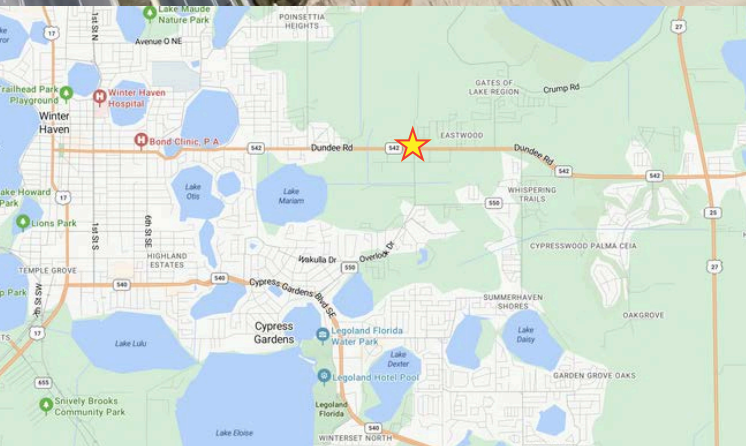

## THE OVERLOOK

### Key Features:

- 1.3 AC available
- Across from New Publix (Opening March 2026)
- Flexible Deal Structures: BTS, Ground Lease, or Purchase
- Seamless cross-access between parcels
- Direct connectivity to the full-access cut on Overlook Drive
- Located on a primary arterial serving as a main entry into Winter Haven
- Booming trade Area
- Excellent regional connectivity positioned between US-27 and US-17
- Signalized Intersection (combined 38,600 AADT)
- Over 580 Feet of prime frontage along Dundee Road

Demographics	1 Mile	3 Miles	5 Miles
2025 Population	4,407	37,105	93,734
2030 Population	5,029	41,076	105,923
2025 Households	1,837	14,897	38,004
2025 Avg. HH Income (est.)	\$104,026	\$93,509	\$92,335

100 Colonial Center Parkway, Suite 230, Lake Mary, FL 32746  
321-363-4955 | [www.TWDRE.com](http://www.TWDRE.com)





# PRIME RETAIL PAD

-1.3 AC | **WINTER HAVEN, FL**

Across from New Publix | Signalized Corner | Pad Ready

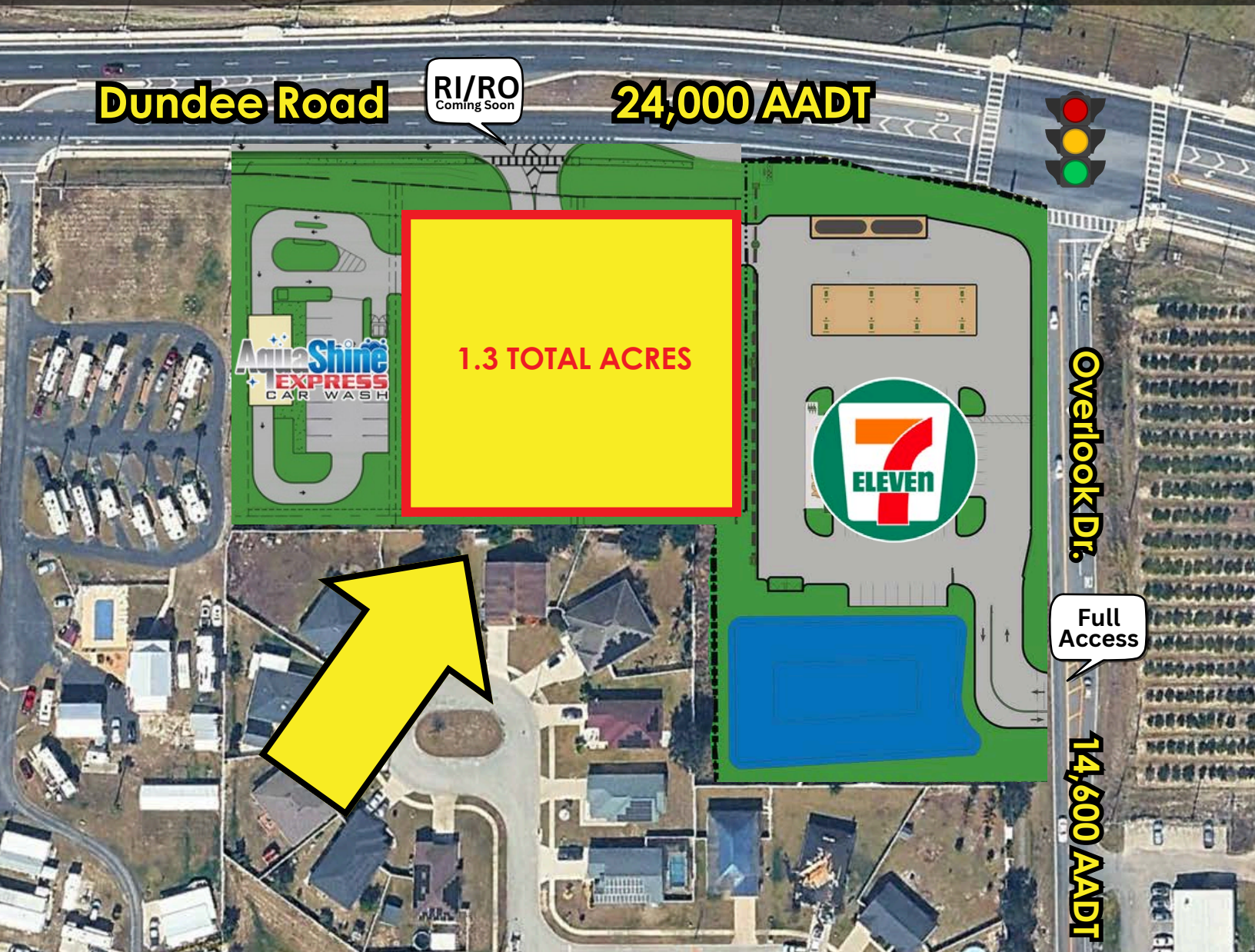

**Available Now!**

**BTS, Ground Lease, or Purchase  
Call for Pricing!**



Rachel Lanham | **407-408-0459**



Rlanham@twdre.com